

## JUXT

with felt trim

The Juxt Mirror is a playful study of adjacency. The smooth luster of the reflective glass is surrounded by the soft density of a single strip of wool felt, enclosed by the rich surface of wood.

This design option features a singular strip of wool felt framing the exterior. The various shapes of the felt-framed apertures, from circles to capsules, and the endless felt color options add to the exuberance of this design. This juxtaposition of materials, shapes, and colors creates a simple, fun, and functional mirror, perfect for vibrant spaces.

Product Number  
**MIRR-SUBM-0027-01**

Product Category  
**WALL ART**

Materials  
**100% MERINO WOOL FELT  
WOOD VENEER  
GLASS MIRROR**

Module Dimensions  
**12" X 12"**

Installed Depth  
**1 3/8"**

Installation Method  
**KEYHOLE BRACKET**

# submaterial

## MODULE DIMENSIONS

Create a one-of-a-kind piece using the module dimensions below.

# 12" X 12"

TRIM VARIATION IN FELT THICKNESS MAY MAKE FINAL DIMENSIONS +/- 1/8"

INSTALLED DEPTH 1 3/8"

MAX SIZE ANY SIZE IS AVAILABLE. THE PIECE MAY BE SPLIT INTO MULTIPLE PANELS DUE TO MATERIAL CONSTRAINTS AND SHIPPING. SEAMS WILL BE PLACED OR HIDDEN IN AN INCONSPICUOUS LOCATION WHEN POSSIBLE.

## CUSTOMIZE SIZE

Variation in felt thickness may make final dimensions +/- 1/8"

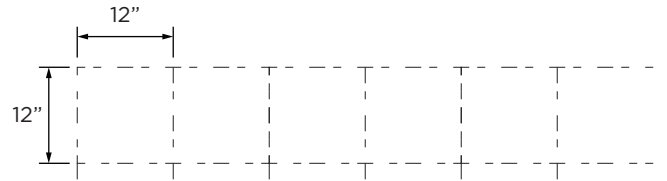

## CUSTOMIZE COLOR

The quantity of colors outside the standard may acquire an upcharge in final pricing. Use the diagrams below to help specify color assignments

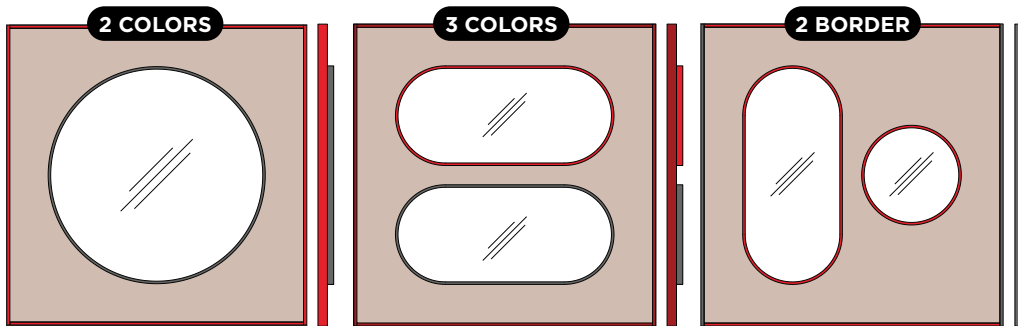

filzfelt

**2 COLORS** CORE PRICING

**3 COLORS** CORE PRICING

**2 BORDER** PREMIUM (+\$)

submaterial **WOOD**

**WOOD TYPE** CORE PRICING

## EXAMPLE DIMENSIONS

When a panel is too large to ship as an individual piece, it may be split up into multiple pieces. The seam will be hidden in an inconspicuous location when possible.

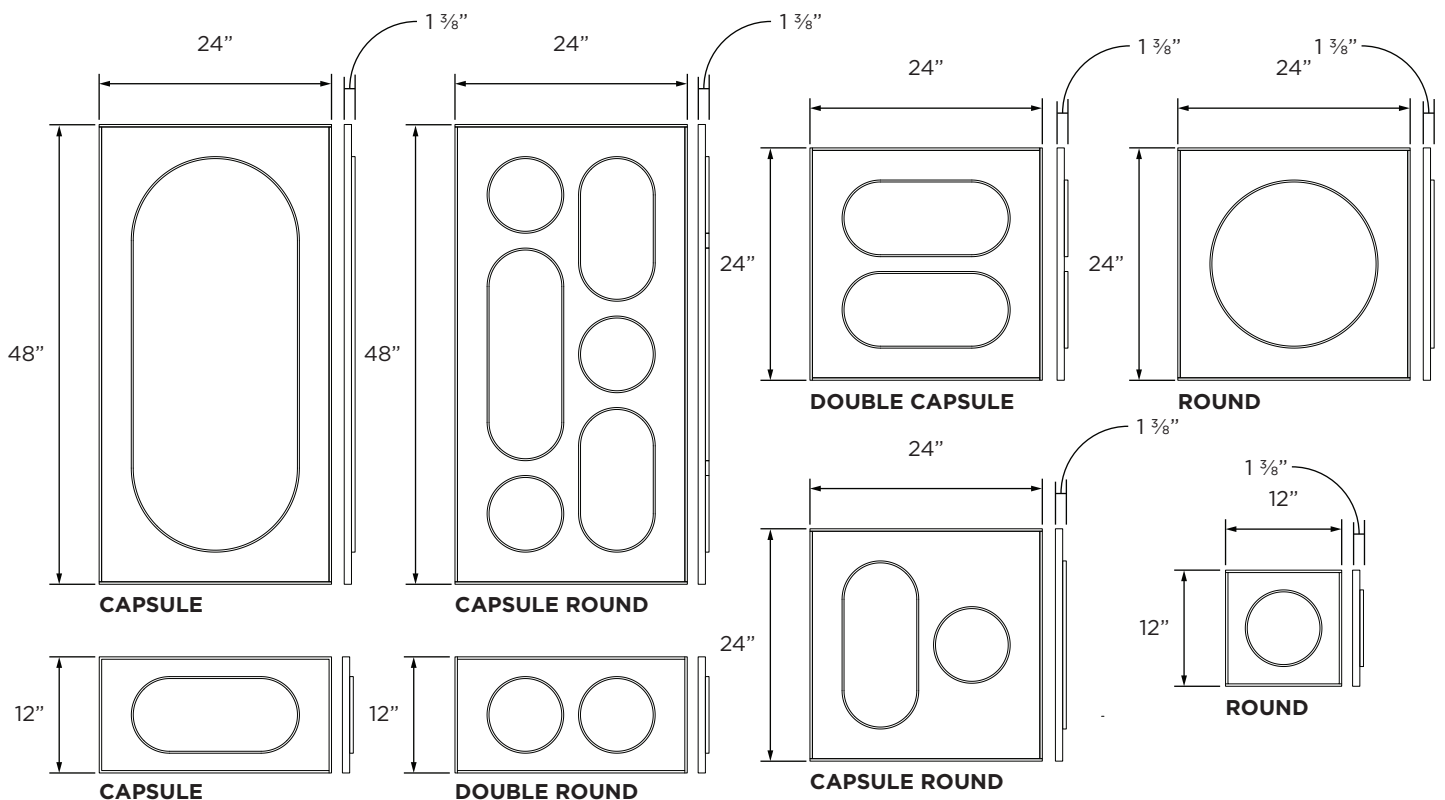

## COLOR + MATERIALS

Be in contact with sales to confirm color and material availability. Some materials have a longer lead time than others due to availability. It is not possible to ensure color consistency in a natural product due to the inherent variations in natural materials and the absorption of dyes, finishes, and grain.

### filzfelt \* 100% MERINO WOOL FELT

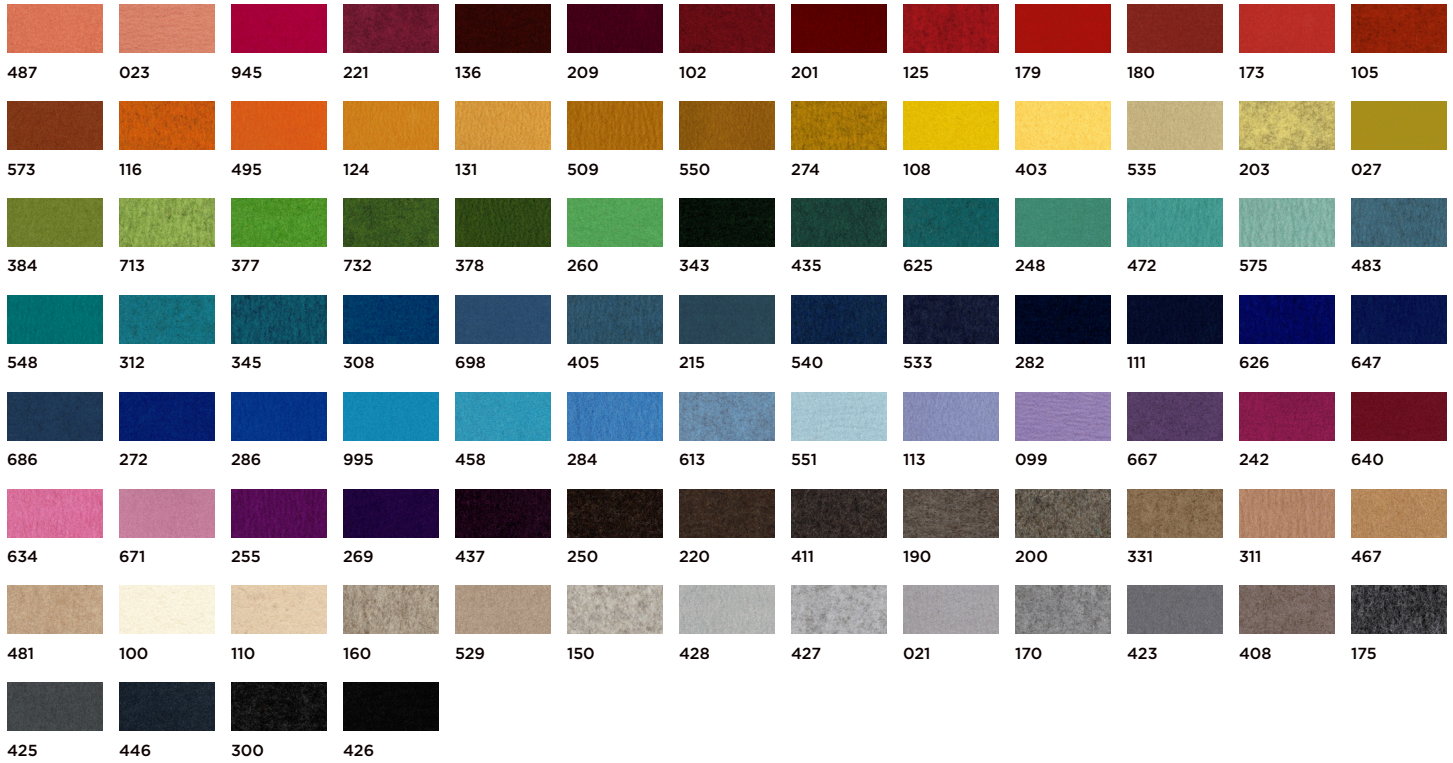

### submaterial WOOD



---

<b>DESIGNER</b>	Submaterial
<b>PRODUCT NAME</b>	Juxt
<b>PRODUCT NUMBER</b>	MIRR-SUBM-0027-01
<b>PRODUCT CATEGORY</b>	Wall Art
<b>MATERIALS</b>	100% Merino Wool Felt,
<b>MODULE DIMENSIONS</b>	12" x 12", Variation in felt thickness may make final dimensions +/- 1/8"
<b>MAX SIZE</b>	Any size is available. The piece may be split into multiple panels due to material constraints and shipping. Seams will be placed or hidden in an inconspicuous location when possible.
<b>INSTALLED DEPTH</b>	1 3/8"
<b>INSTALLATION METHOD</b>	Keyhole Bracket
<b>MAINTENANCE + CLEANING</b>	The preferred steps taken for the cleaning process should consist of (in order of intensity): dusting with a lint roller, vacuuming with a clean soft brush, spot cleaning with water and mild detergent, using chemical stain removers. Periodic spot removal of lint can be achieved easily by using a standard tape lint roller. Once per year, it is recommended that the entire surface be given a light vacuum with a soft upholstery brush. Light dusting with a gentle cloth, on hard surfaces, is recommended. Most hard surfaces can take a light application of a natural, neutral-based cleaner, wiped away with a soft cloth.
<b>LEAD TIME</b>	Products on hand will ship out 2-3 business days and will use client's preferred method of shipping. If no preferred method of shipping is mentioned, ground shipping will be chosen. For custom orders, be in touch with sales for accurate lead times. Lead times depend upon material sourcing.
<b>SUSTAINABILITY</b>	<p>100% Merino Wool Design Felt is all-natural and fully biodegradable. Additionally, it contributes to ©LEED certifications.</p> <p>Akustica is crafted from PET (polyethylene terephthalate). By utilizing PET and ensuring recyclability, Akustica minimizes its environmental footprint while offering an eco-conscious solution for acoustic needs. This material contains no formaldehyde, is 100% VOC-free, devoid of chemical irritants, and free of harmful substances.</p> <p>Cork used in our products is sustainably and efficiently sourced from Portugal, ensuring it is 100% VOC-free and devoid of chemical irritants or harmful substances.</p> <p>Ultrasuede, a premier synthetic blend of microfiber, incorporates plant-based polyester in its composition.</p> <p>Vegetable tanned leather is considered more sustainable due to its eco-friendly production process, which involves using natural tannins derived from plant sources such as tree bark or leaves. This method reduces reliance on harsh chemicals commonly used in other tanning processes, resulting in a leather product that is biodegradable and less harmful to the environment.</p> <p>Wood used in our products is sourced responsibly, ensuring that our materials come from responsibly managed forests or recycled sources to minimize environmental impact. Additionally, we utilize catalyzed vinyl sealers in our products to provide a durable and long-lasting finish while adhering to high standards of environmental responsibility in our manufacturing processes.</p> <p>Metal used in our products is locally sourced in the state of New Mexico when possible, and we powder coat our metal to ensure a lasting finish. Powder coating is celebrated for its sustainability, boasting minimal waste generation and lower volatile organic compound (VOC) emissions compared to traditional liquid paints. Its durable nature also extends product lifespans, reducing the need for frequent reapplications and contributing to resource conservation.</p> <p>Glass is favored over plastic for sustainable reasons due to its inherent recyclability and durability, reducing environmental impact by minimizing single-use waste. Its inert nature also ensures that it does not leach harmful chemicals into the environment, further contributing to a healthier ecosystem. Our mirrored glass is locally sourced.</p>
<b>VARIATION</b>	It is typical for the natural materials to exhibit variations in color and thickness, and the presence of natural fiber inclusions on the surface is considered normal. Consistency in color matching cannot be assured for shipments, and slight variations may arise due to changes in dye-lots. The use of natural materials inherently results in product-to-product variations influenced by factors like humidity and finishing methods. For optimal color matching results, we encourage you to communicate with Sales regarding any specific concerns. While Submaterial strives to achieve color coherence in orders, there is no guarantee.
<b>WARRANTY + RETURNS</b>	No warranties are offered on any Submaterial products. Most of our products are made to order, therefore we offer returns or exchanges due to manufacture's defect only. Items must be returned in the original packaging and have no visible signs of wear or use. If you have a concern, please contact us within 3 business days of receipt of your products. Please retain the original packaging and wait for instructions from our sales team.